

HiLo®

4G

LS1-R Radar level Monitor

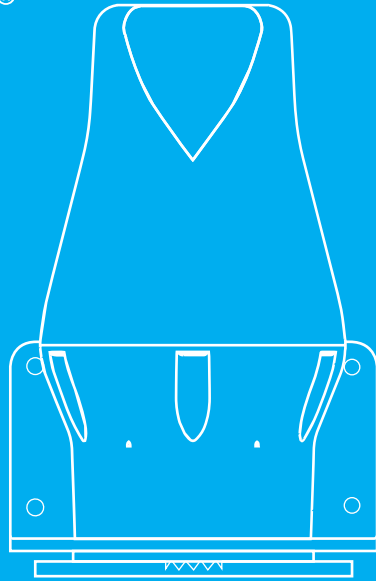

v1.4

1. Welcome to HiLo

An email has been sent to you with a link to create your HiLo account.

Follow the link to complete your account setup.

If you haven't received an email, let us know and we'll sort it out.

2. Download the App

Using your mobile phone, search for the [HiLo Mobile App](#) in the Play Store for Android or the App Store and install.



Log into the app using the email and password you have set in your HiLo Live account.

Need help? Chat: hilomonitoring.com
Guides: help.hilomonitoring.com
Email: support@hilomonitoring.com

Phone: NZ (+64) 3 477 2779
AUS (+61) 7 5300 2959

3. Ready to Install Your Monitor?

Now that you have created your account it's time to install and then set up your monitor via the app.

You'll need to be [at your installation site](#) when you are ready to follow the Setup Wizard steps.

Tools you'll need:



Magnet wand
(supplied)



4 X screws
(not supplied)

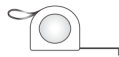

Measuring Tape

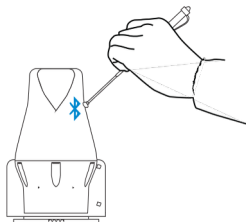

The magnet wand is used to activate the Bluetooth connection during the Setup Wizard

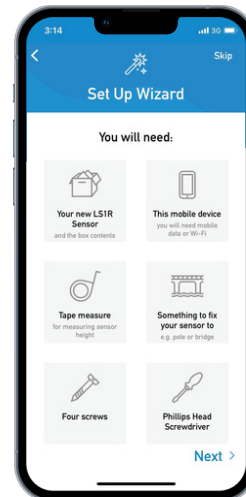

Select to begin the
Set Up Wizard

The Set Up Wizard will help you to:

- ◆ Connect to your monitor via Bluetooth
- ◆ Check your 4G coverage
- ◆ Mount your monitor
- ◆ Measure and enter the offset
- ◆ Verify your first measurements
- ◆ Name your monitor

NOTE

For the best results your monitor should be installed at least 300mm above the highest water level.

Environmental monitor measurement ranges:
7 meter variant 0.3m - 7m
12 meter variant 0.5m - 12m

Offset

The offset is the measurement between the monitor and the base point. The base point could be the bottom of a stream, culvert or even at sea level depending on what you are measuring.

The monitor can then calculate the real water level (A-B) rather than the distance between the monitor and the top of the water.

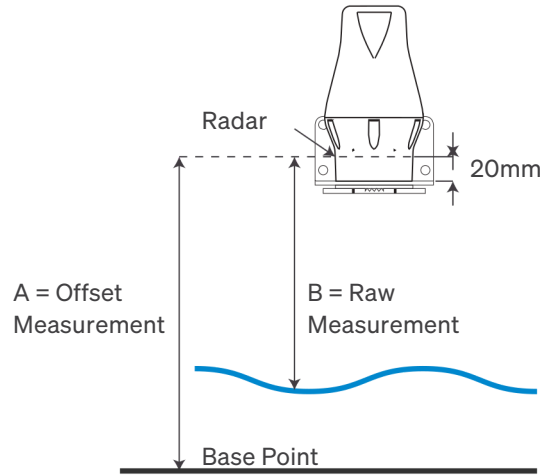

Tips for successful installation

The monitor measures the distance to the water by bouncing signals off the water surface and back to the radar sensor. If the signal hits objects like rocks and grass or the monitor is on an angle, it may not incorrect measurements.

- Ensure there is no grass, weed, or other floating material that could impact the radar signal.
- Mount the monitor as level as possible with no more than a three degree angle.
- If the monitor will be measuring to a dry surface, the surface should be a flat, hard surface for reliable results e.g. concrete.

NOTE

For the best results your monitor should be installed at least 300mm above the highest water level.

Environmental monitor measurement ranges:
7 meter variant 0.3m - 7m
12 meter variant 0.5m - 12m

Installation examples

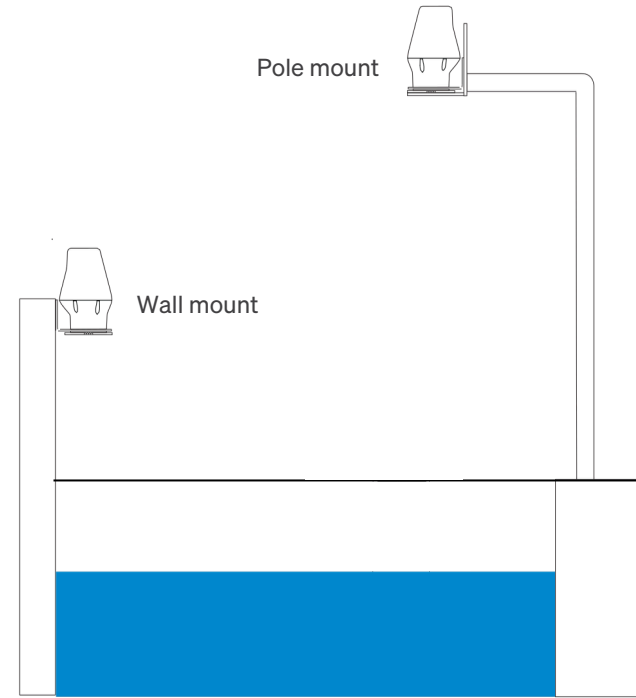

Quick App Guide

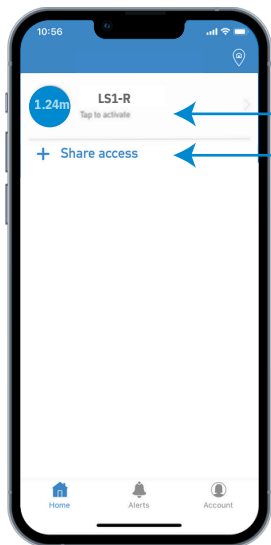

Select to view your water levels and settings

Click to invite others to view your water levels.

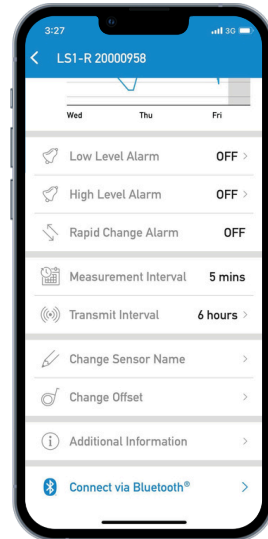

Change alarms remotely

Connect to your monitor via Bluetooth

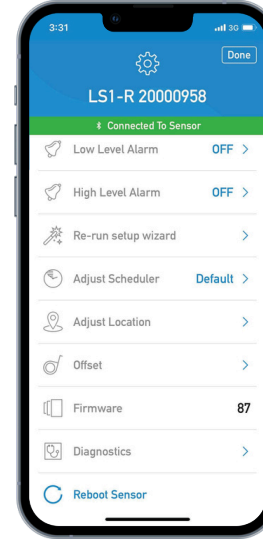

Adjust your scheduled updates

Change offset

Connect to your monitor via Bluetooth to access this screen

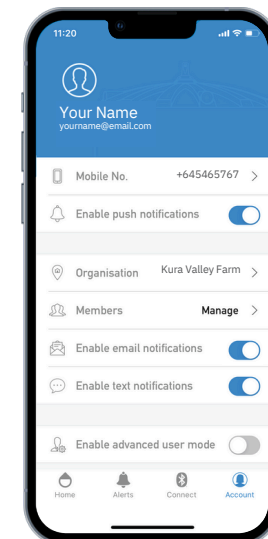

Turn on to receive pop up alerts on your phone

Select to view & change member permissions